

## Connector Standard High Temperature

Connector for thermocouple and RTD circuits. Solid pin design ensures good contact even in demanding applications. Thermoset material designed for use at high temperatures. Hollow pin design offers a good quality product at competitive pricing for less frequently used connectors.

### **Construction:**

- Body of thermoset material with original thermocouple material pins and springloaded inserts.
- Polarized pins ensure proper connection.
- Easy wire connection through sandwich construction.
- Molded barriers prevent short circuit.
- Rugged one body design.

### **Wire size :**

- Accepts wires up to 1,6 mm.
- Maximum cable diameter 8,0 mm.

### **Temperature rating :**

350°C Max.

### **Color Code:**

Color of the connector-body is brown, calibration K indication printed on body

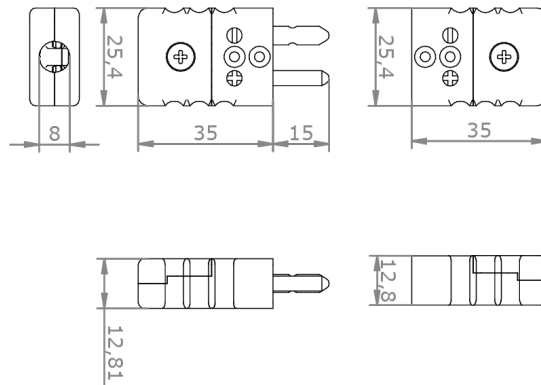

Sensor type	E	J	K	N	T	U	R/S	C	B
Material Positive	NiCr	Fe	NiCr	NiCrSi	Cu	Cu	Pt13Rh/ Pt	W5Re/ W26Re	Pt6Rh/ Pt30Rh
Material Negative	CuNi	CuNi	NiAl	NiSi	CuNi	Cu	Cu Alloy #11	CPX CNX	Cu Cu