

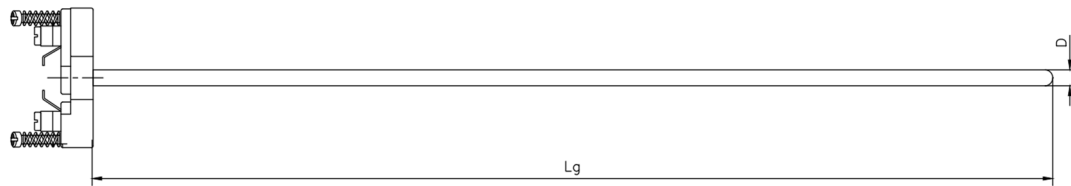

TERMOCOPPIA AD INSERTO ESTRAIBILE CON ISOLAMENTO MgO
Thermocouple with removable insert and MgO insulation

TDM



Termocoppia modello TDM, ad inserto estraibile con isolamento in ossido minerale, compatibile con tutte le tipologie di teste di connessione e pozzetti.

Removable insert thermocouple with mineral oxide insulation, model TDM, compatible with all types of connection heads and thermowells.

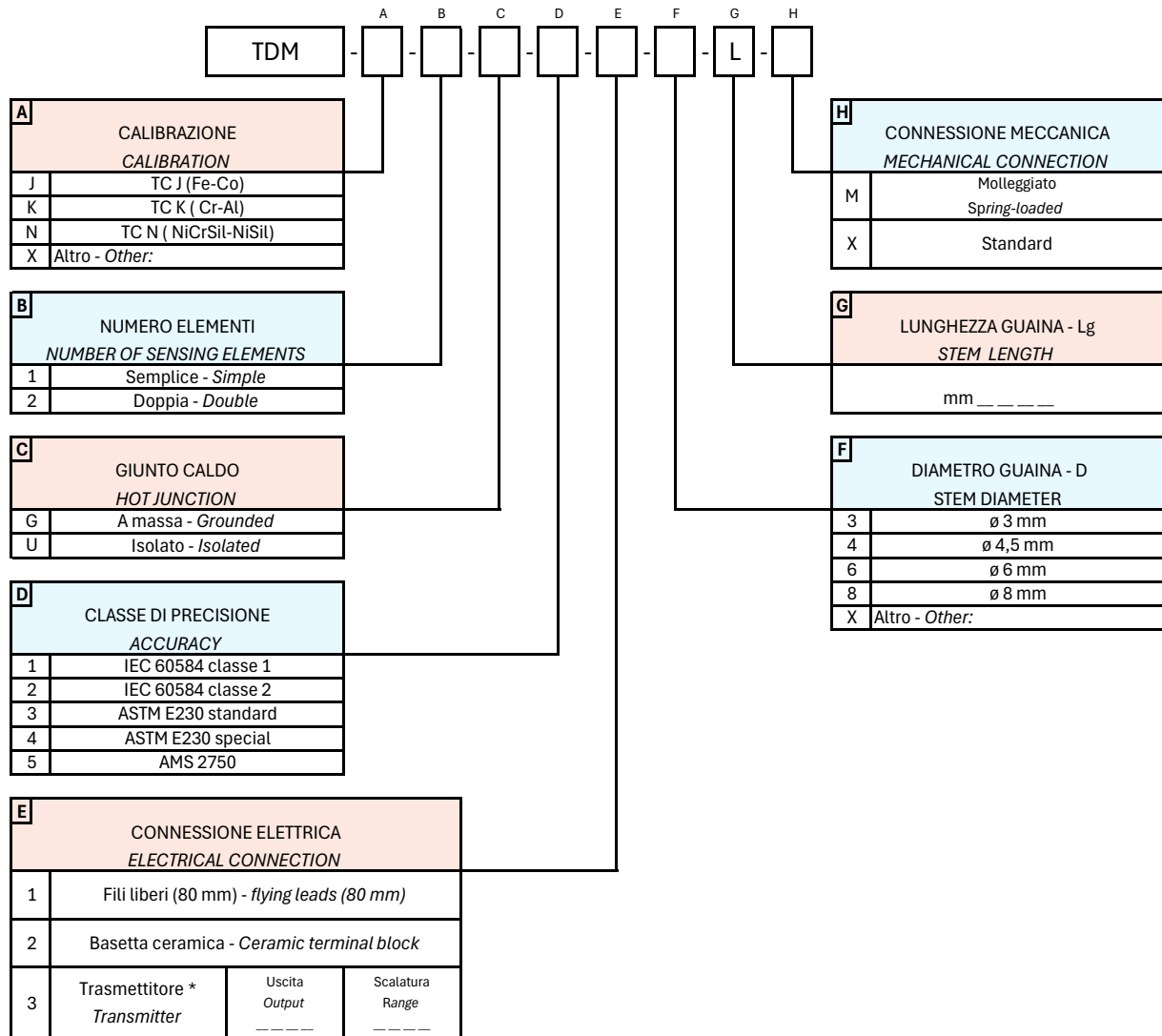

* Trasmittitori a pag. 123 - *Transmitters page 123*