

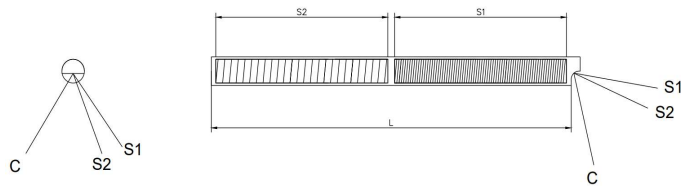

CARTRIDGE HEATER WITH
2 EQUAL DIFFERENTIATED DEPENDENT SECTIONS
AND PERPENDICULAR CABLE EXIT

XLD2D-S



Cartridge heater model XLD2D-S, with 2 equal-sized differentiated dependent sections and perpendicular cable exit. Body can be made with various types of steel depending on the application. Two phases most commonly exiting from one side. The cables have 2 different colors to distinguish phases from common. The phases are also numbered to identify the relevant section. The common cable cross-section will be sized according to the total power of the heater. All heaters are equipped with an additional silicone sheath approximately 80 mm long to protect the cable outlet from the heater. Sealing defined according to the application and the characteristics of the heater.

	A	B	C	D	D	E	F	G	H										
XLD2D-S	-	-	-	S1	-	S2	-	T	-	C	-	-	-	-	-	-	-	-	-

A	DIAMETER		
A		12,5 mm	
B		16 mm	
C		20 mm	
D		1/2"	
X		OTHER _____	

B	LENGTH - L		
M		mm _____	
I		in _____	

C	Vac		
A		24	
B		110	
C		220	
D		230	
E		400	
X		OTHER _____	

D	Watt PER SECTION		
S1		_____	
S2		_____	

	SHEATH MODEL (see page 121)		H
S		standard single insulation 80 mm	
U		single silicone sheath **	
G		metal sheath **	
C		metal braid **	
X		OTHER _____	

	GROUND *		G
A		with ground wire (only for ø 16 mm and ø 20 mm)	
X		without ground wire	

	OPERATING TEMPERATURE OF THE CABLE		F
		°C _____	

	CABLE LENGTH		E
		mm _____	

* Of the same length as the cables

** The sheath length is always considered to be 100 mm shorter than the total cable length. The sheath diameter is defined by the manufacturer based on the resistor's specifications.